

## YOUR CONTACT DETAILS

Customer: .....

Reference: .....

Address: .....

Email: .....

Tel: .....

Date: .....

Delivery Address: ..... Same as customer

Kit Form  Yes  No (£25+VAT for Kit Form)

### Wind Loading Calculation required?

Yes  No

(If yes, please complete the form right)

Postcode: .....

Altitude: .....

Wind Load  600  800  1000  1200  1400  1600  1800

2000  2200  2400

Distance to Sea:  0-6.5 Miles  6.5-32 Miles  32+ Miles

Location:  Exposed  Shelter

Building Height:  0-3m  3-6m  6-10m  10-15m

If the above information is not provided we cannot accept responsibility as to the suitability of our products for installation

### Configurations:

Single Doors using Bifold Sash profile

Mirror

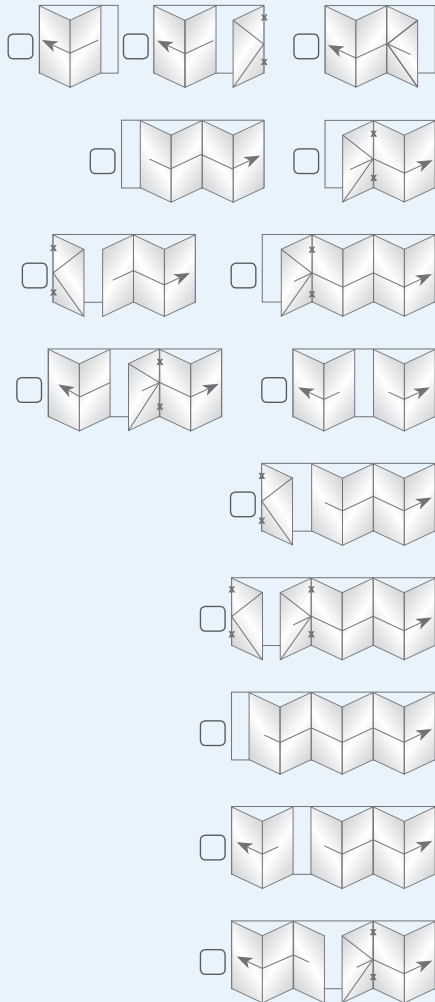

### Bifold Quantity:

Threshold:  Standard  Low  Internal (22mm)

Opening:  In  Out

Dimensions (mm) Width: ..... Height: .....

Midrail Height: .....

(Overall sizes to include cills and add-ons (transoms, mullion and midrail sizes are excluding cills and add-ons)

Cill Size  Yes  No

95mm  150mm

190mm  225mm

Drainage Colour  Face  Concealed  None

White  Grey (7016 Matt)  Black (9005 Matt)

Non-Stock RAL ..... In ..... Out .....

Dual Colour  Yes (in 40mm Add-On to head)  No

4000  8000

Glazed  Unglazed

If unglazed, please supply glass Specification and Unit Depth in notes

Hardware Colour  Black  Silver  White

Traffic Door Handle Colour  Black  Silver

White  Chrome

Locking T-Handle (Shootbolt)  Yes  No

T Handle Colour  Black  Silver

White  Chrome

Extras  Ultion Cylinder  PAS24; 2012 (Document Q)

NOTES:

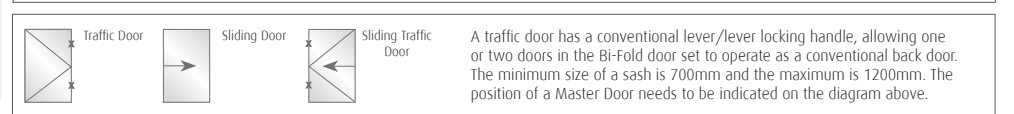

Customer: ..... Job Ref: .....

Signed: ..... Date: .....



## DELIVERY DATES

All delivery lead times are from the date we receive a signed off order. Any amendments thereafter will usually result in delay to the anticipated delivery date.

It is the customer's responsibility to inform the window outlet of any delivery requirements at the point of order. Failure to do so will result in the delivery being made at the window outlet's convenience.

## DELIVERY IS TO KERBSIDE ONLY

Aluminium is not like PVCu because stock is not generally held by the fabricator. This, combined with powder coating lead times means manufacturing lead times are longer. If faulty materials are delivered to us or materials are not available from our suppliers, this can delay delivery to the trade customer and we advise that your customer is made aware of this possibility at the outset. Should we become aware of any potential delay in the supply of your order, we will advise you in writing at the earliest opportunity.

**On this basis we advise you not to schedule any installation until goods are received and checked by you. We are not liable for any costs or penalties incurred arising from any delay in our anticipated delivery date.**

Problems can also occur due to delays in architects / customers sign-off or change in specification. Therefore it is recommended that you should include the following in your quotation / correspondence for aluminium contracts.

**"Delivery dates quoted are from the date orders are signed off and / or from the date sizes can be taken on site.**

**Any amendments to the order or delays in obtaining site measurements or sign off by the architect or customer will delay the delivery date quoted"**

In addition, it is very important that your quotation / order is subject to your terms and conditions that **"time is not the essence of the contract"** so if any delay occurs for any reason, the customer cannot cancel or ask for compensation. All verbal instructions or amendments and the implications on delivery date should be confirmed to the customer or specifier in writing.

**We would respectfully advise that as this is a supply only contract it is your responsibility to ensure that all sizes, specifications and products shown are correct and suitable for the situation in which they will be used.**

**The end user should be made aware of cleaning and maintenance requirements. In areas within the direct influence zones of salt water, industrial chemical plants, blast furnaces or other aggressive emission sources, the window should be cleaned at least every three months. In a relatively cleaner environment every six months should be sufficient. For full details please refer to the cleaning and maintenance manual available for download at [www.the-window-outlet.co.uk](http://www.the-window-outlet.co.uk)**

All orders are subject to our terms and conditions of sale which are available on our website [www.the-window-outlet.co.uk](http://www.the-window-outlet.co.uk)

### Bifold Standard Threshold

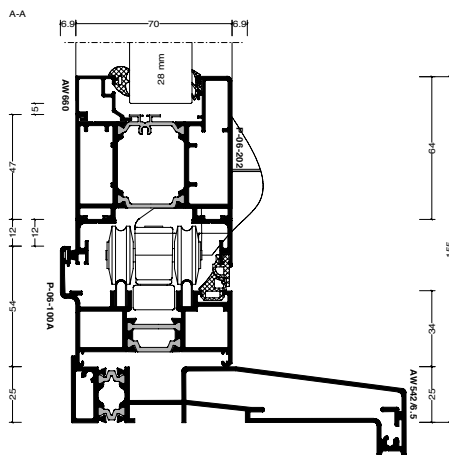

### Bifold Low Threshold (34mm)

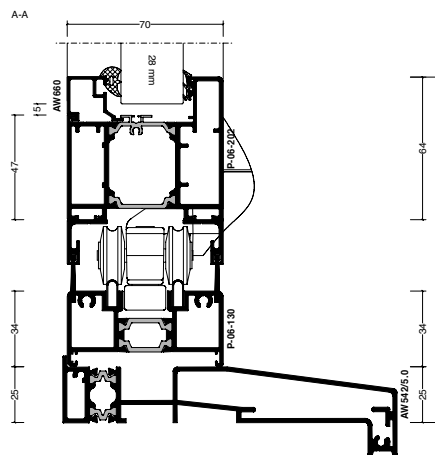

### Bifold Internal Threshold (22mm)

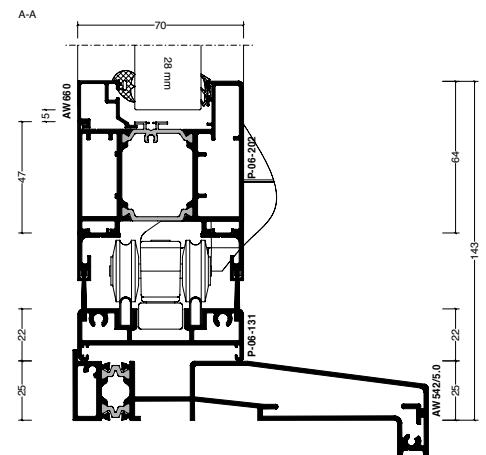

## DELIVERY AND RISK

(a) Any delivery date or time stated by the seller shall be approximate only and time, whether of delivery or otherwise, shall not be of the essence and the seller shall be under no liability whatsoever in respect of any loss due to late or early delivery, howsoever arising.

(b) If the buyer fails to take immediate delivery of goods, the subject of any order, when delivery is tendered by the seller, the seller shall be entitled to:

- (i) immediate payment in full for the said goods and
- (ii) the costs, if any, incurred in storing the said goods and
- (iii) any further or other costs caused by the buyer's said failure to take immediate delivery

(c) Goods, the subject of any agreement between seller and buyer, shall be deemed to have been delivered and the risk therein shall pass, upon delivery to the buyer's premises or to his order or, where goods are transported by the buyer or his servant, agent or carrier, delivery shall occur and risk shall pass upon collection of the goods by the buyer, his servant, agent or carrier.

(d) Goods shall be deemed to have been delivered in good condition and in accordance with the terms of the agreement between buyer and seller unless the buyer notifies the seller to the contrary in writing within 48hrs of delivery.

In the event of defective delivery properly notified and established by the buyer, the seller shall, in its absolute discretion, either replace the ordered goods or credit the buyer with the full purchase price but shall be under no liability for further or consequential loss to the buyer, howsoever arising.



**The Window Outlet**  
a fresh approach to aluminium

Unit 11 Liberty Industrial Estate  
South Liberty Lane Bristol, BS3 2SU

T: 0117 405 8488 | F: 0117 405 8487 | E: [sales@thewindowoutlet.info](mailto:sales@thewindowoutlet.info)

W: [www.the-window-outlet.co.uk](http://www.the-window-outlet.co.uk)